

November 2015

second floor plan

Gielgud | Redgrave | Burton | Olivier | Victoria | Albert



second floor

	Redgrave + Burton combined	Gielgud	Olivier	Burton	Albert	Victoria
Capacities						
Theatre	100	120	70	40	80	80
Classroom	56	64	36	28	40	40
Boardroom					32	32
Banquet					50	50
Cabaret	56	56	49	28	35	35
Reception					80	80

Please note that these figures are subject to change according to safety requirements, legislation and AV usage.

Dimensions
 Height (max)
 Height (min)
 Length
 Width
 Area

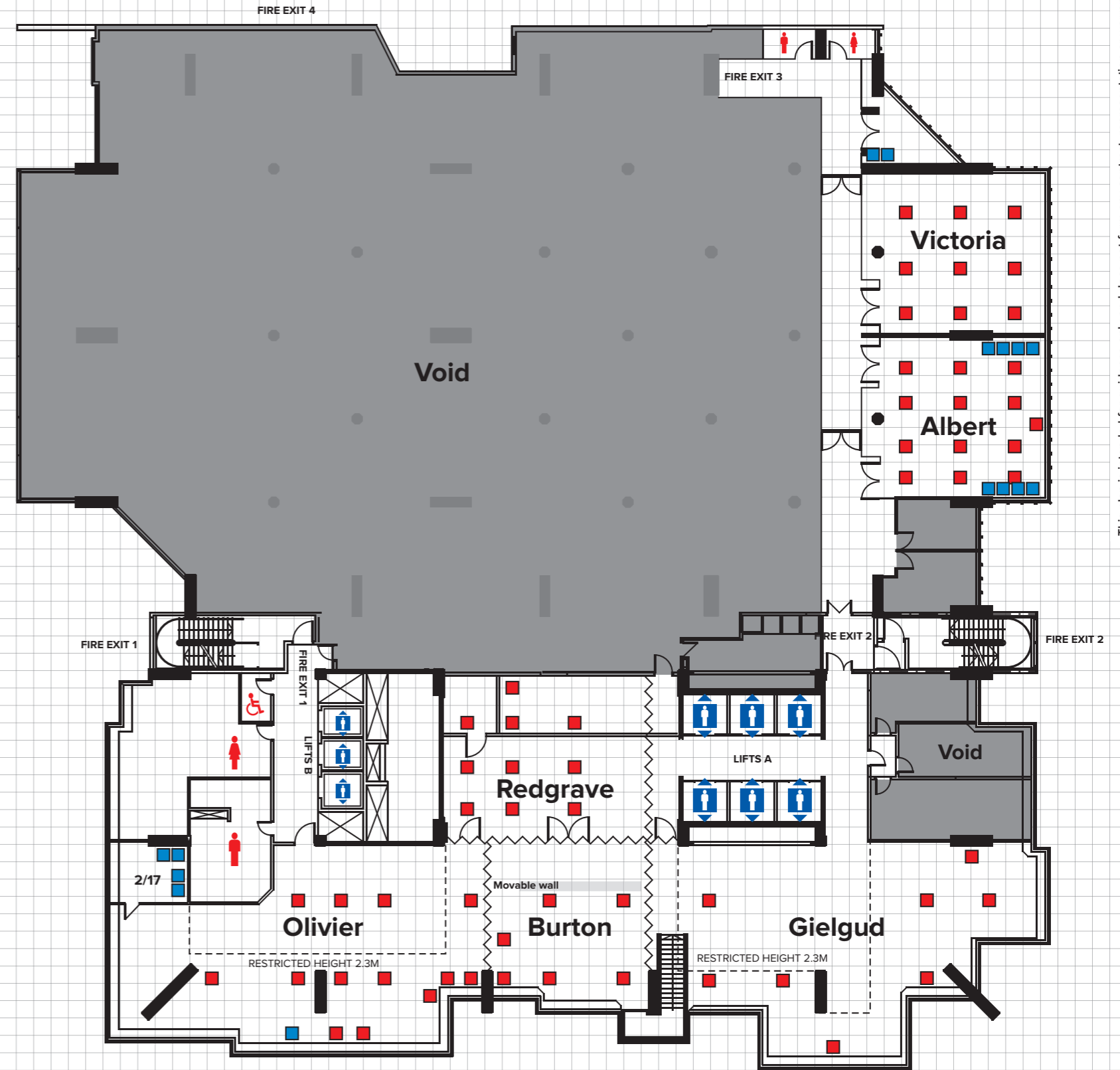

Key

13 amp wall socket	Power 3 phase 63A	Sound control	Lift: Goods	Help phone	Lighting bars
Electrical floor sockets	Power 3 phase 32A	Fan housing	A/V Control Room	House phones	Pillar
Power 3 phase 125A	SI booth	Lift: Passenger	Induction loop	Toilets	

Scale in metres
 0 2 4 6 8 10

This plan is intended for guidance only and does not form any contract, representation or warranty, expressed or implied.